

# PREMIUM WOODEN DOUBLE BIN STORE

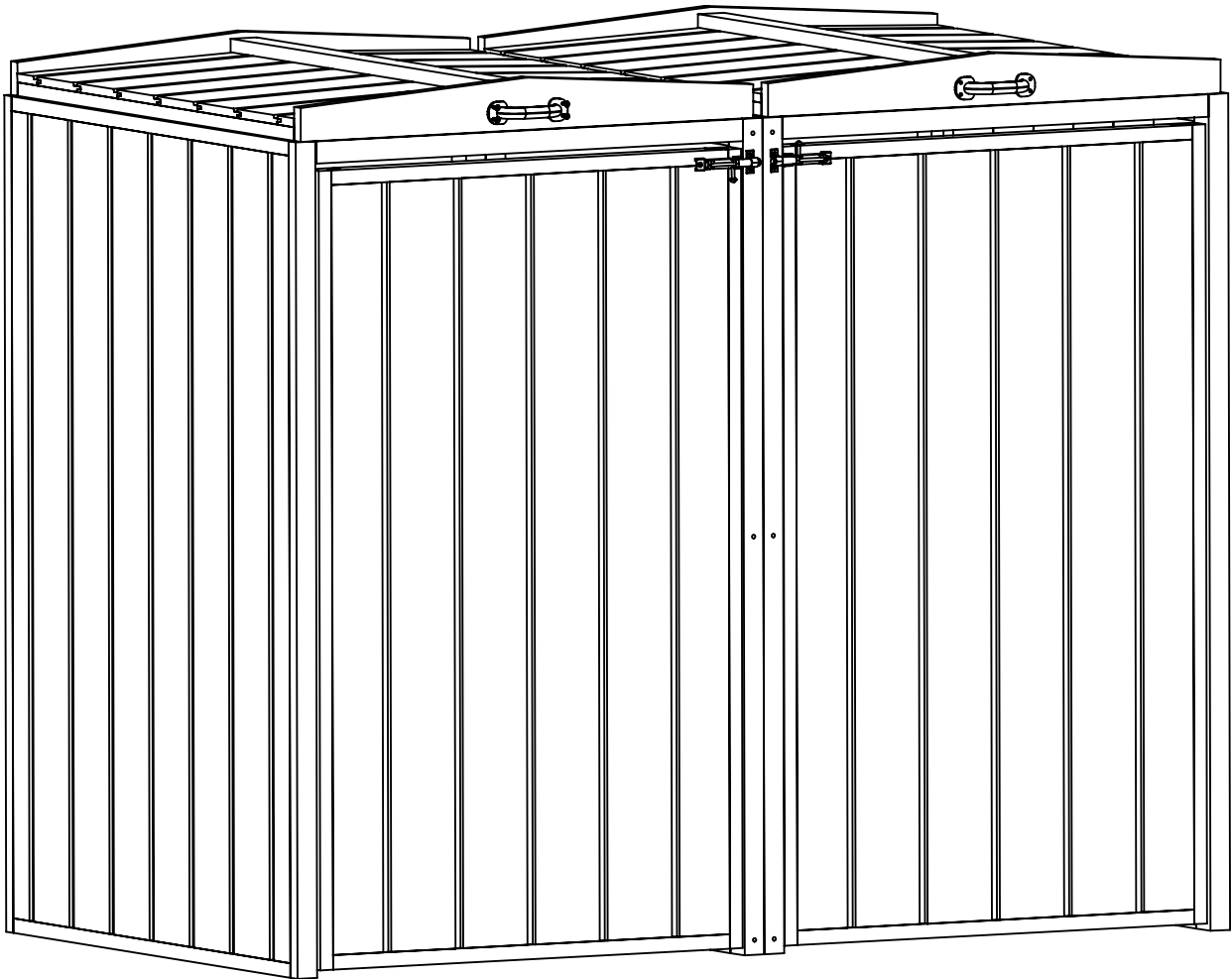

# PREMIUM WOODEN DOUBLE BIN STORE

## ASSEMBLY INSTRUCTION

### Before assembly

- We recommend that time is taken to read the instructions before starting assembly, then follow the easy step by step guide. The instruction sheet is only a guide to the assembly.
- Certain items may not be shown to scale.
- Check all components prior to assembly
- This product should be assembled by no less than two people.
- Never attempt to erect the assembly in high winds.
- Drill all components where indicated.

### Recommended tools for assembly:

- Drill with 3mm diameter drill bit
- Cross head screw driver
- Hammer

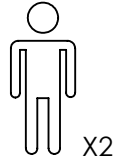

Side wall 2pcs

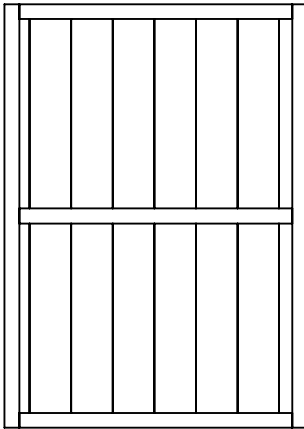

Door 2pcs

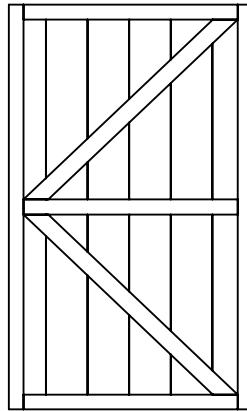

Lid 2pcs

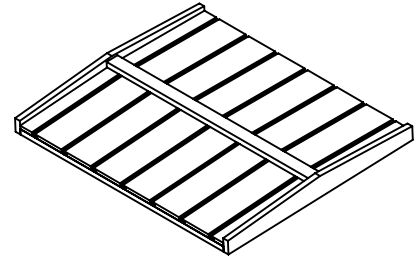

Middle frame 1 4pcs

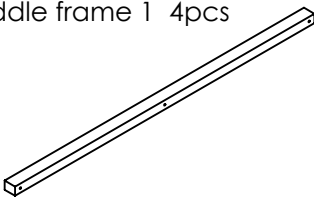

Middle frame 2 6pcs

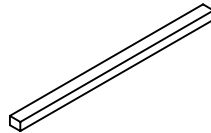

Connection bar 6pcs

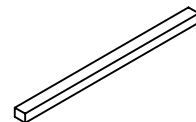

Back wall support 8pcs

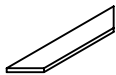

Front rail 2pcs

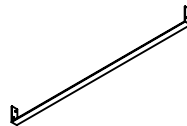

Handle 2pcs



Chain 2pcs



Tower bolt 2pcs

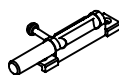

Hinge 8pcs

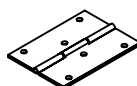

No	Fixing kit	Qty
1	70mm screws	12
2	60mm screws	12
3	50mm screws	8
4	40mm screws	32
5	30mm screws	24
6	20mm screws	52
7	25mm round head screws	2

### 1. Middle Frame

Connect the 2 no of the vertical frames and the 3 no of the horizontal frames as shown below using 6 x 70mm screws. Repeat this procedure to connect the second middle frame in the same way.

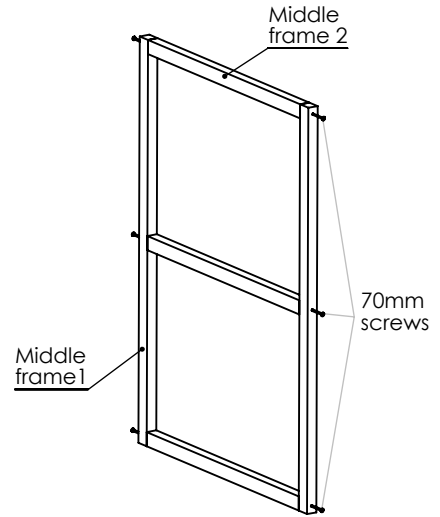

### 2. Side Panels

Secure the three pcs of the connection bars between one of the side wall panel and the middle frame using 6 x 60mm screws. Back wall corner supports secure with 4x40mm screws per one support. Repeat this procedure to connect the right hand wall section.

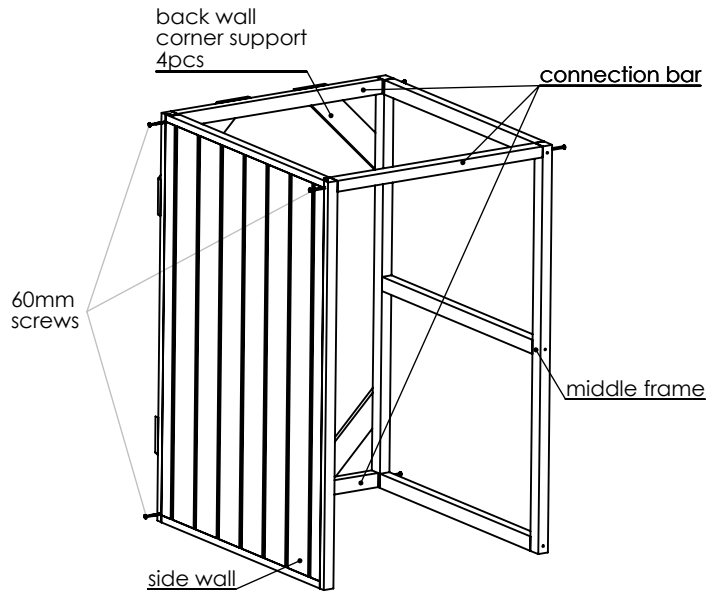
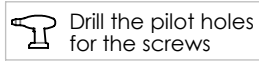

### 3. Connection of the Wall Panel Sections

Secure the right and the left hand wall sections as shown on the drawings using 8 x 50mm screws. The metal rail connects with 20mm screws.

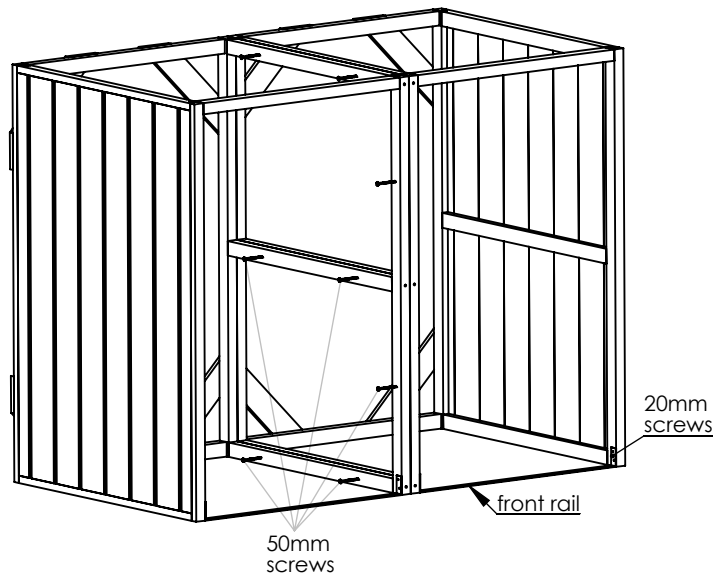
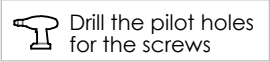

#### 4. Doors

Position a towerbolt at the top of each door and their catch plates on the middle frame as shown. Ensure the bolts align with the catch plates so that the bolts fits in the catch plate when in the locked position. Secure each bolt using 4 x 20mm screws and 2 x 20mm screws for each catch plate.

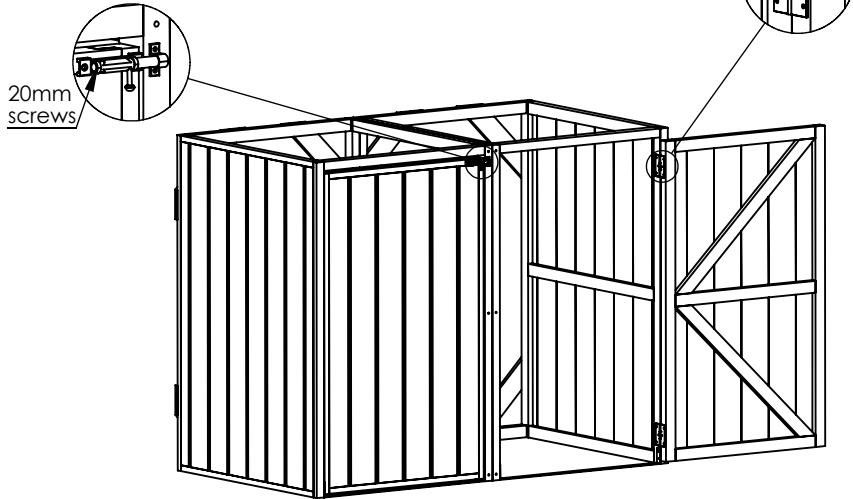

Secure two hinges to the each door using 3 x 30mm screws per hinge. Position the doors in place and mark the right hinge position on the side wall front frames. Open the doors and fix the hinges to the side wall front frames using 3 x 30mm screws per hinge.

#### 5. Lids

Place the both lids on to the body of the assembly and at the back attach two hinges per lid and fix with the 6x20mm screws per hinge.

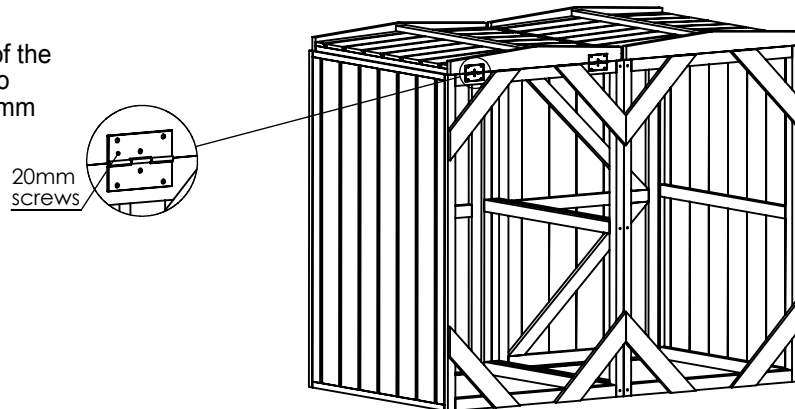

#### 6. Handles, chains

Attach the handles to the front of the lids using 4x20mm screws per handle. Attach one chain to each lid. Screw through the end link of each chain into the side of the lid frame as shown using 1 x 25mm round head screw.

